

# Community Update

## Türkiye

Hakan Bayındır, Ph.D.  
*TÜBİTAK ULAKBİM*

---



## Who We Are?

---

- **National Research Network:** Operator and administrator of nation-wide academic research network.
- **National HPC Center:** 25K Cores, 216 GPUs (P100, V100, A100), 14PB of storage, 4000+ users with ~350 active users any given time.
- **EGI Cloud & HTC Site:** Home of TR-FC1-ULAKBIM, TR-03-METU & TR-10-ULAKBIM
- **Long Term Project Partner:** Participating in the ecosystem since SEE-GRID (2005).



## EGI-ACE & Beyond

---

- Resource provider in EGI-ACE
  - Supported PROMINENCE, ENES, Agiliacenter & EISCAT
  - Still supporting some of them, post-project
- Cloud – HPC integration pilot site
  - SSH-OIDC based login systems with KIT
  - Support PoC use cases in tandem
  - Contributor of Integration Handbook

## EGI-ACE & Beyond

---

- Member of iMagine and EuroScienceGateway.
  - Providing GPU resources to iMagine
  - Deploying a Galaxy endpoint for EuroScienceGateway
- Continuing Cloud – HPC integration efforts
  - Hardware upgrades
  - More tests
  - Maybe moving to production

# Our New Datacenter

- Building a new datacenter for all teams
  - Direct liquid cooling
  - Air cooling support for older systems
  - Busbar power
  - Integrated fire suppression

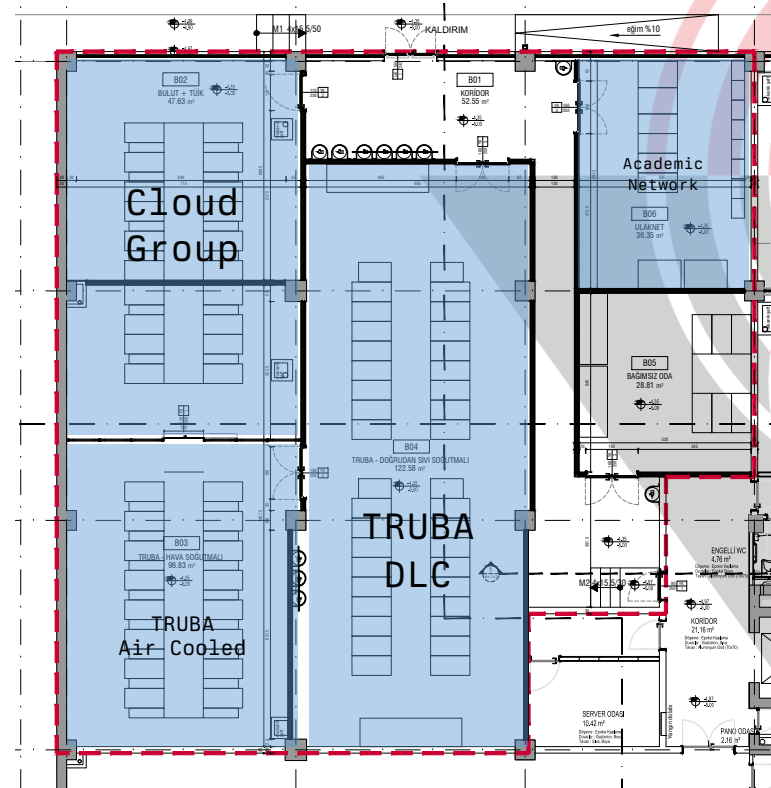

## Our New Datacenter

- New systems are denser
  - Needs more power
  - Generates more heat
- Aging infrastructure
  - Capacity losses
  - Hardware failures
  - New systems are more efficient

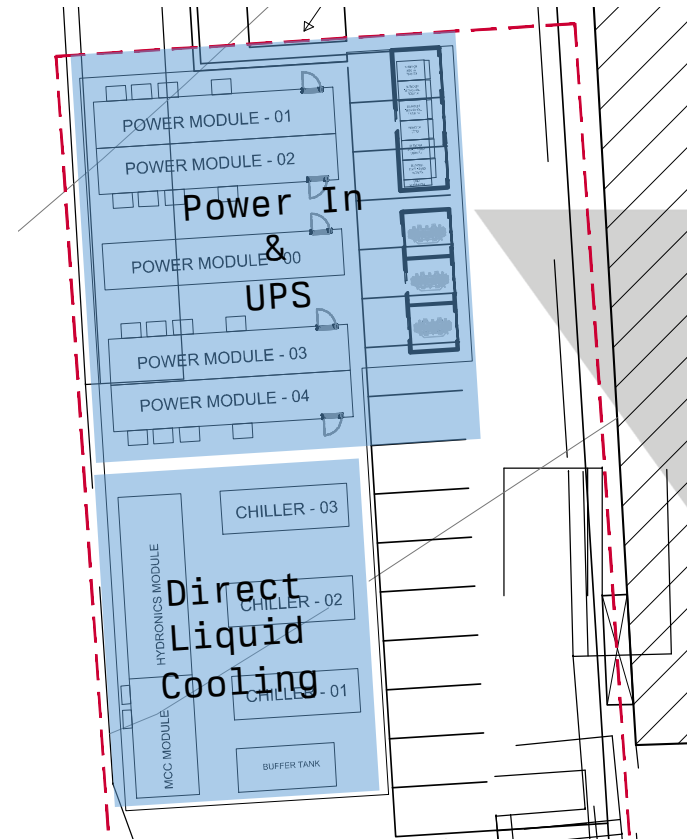

Thanks!

